

The Swiss Raclette Basics

Ratgeber • Guide • Manuale

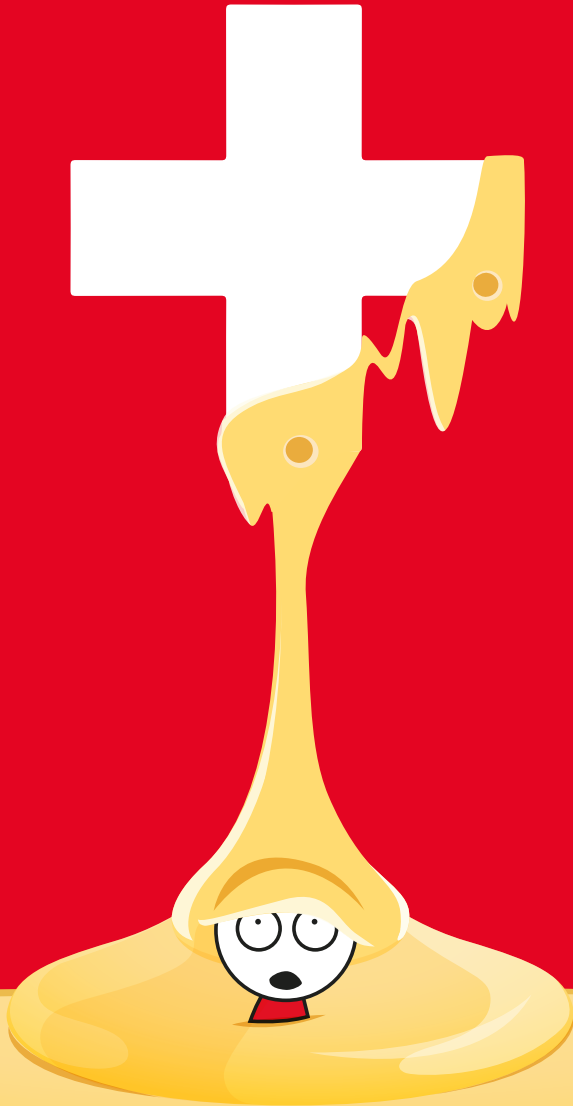

Ausrüstung • équipements • equipaggiamento • equipment

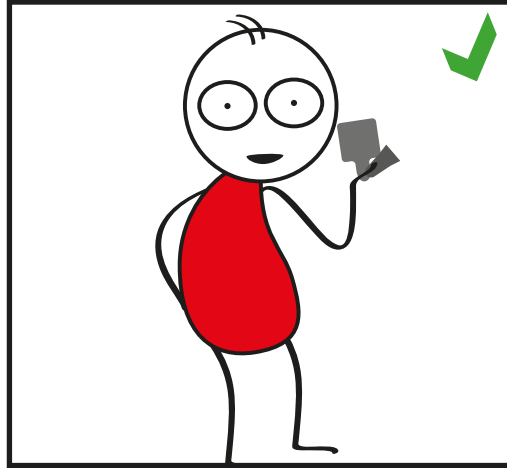

Aufstellen • installer • montaggio • set up

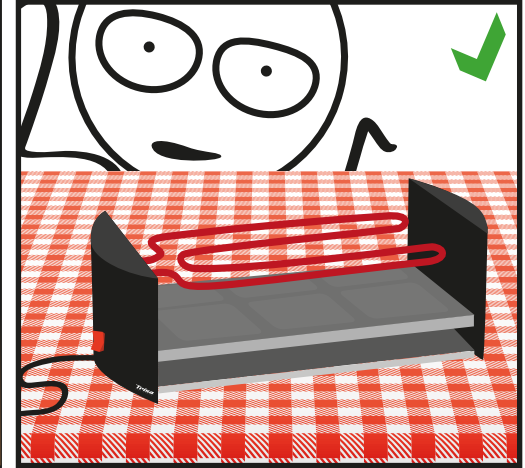
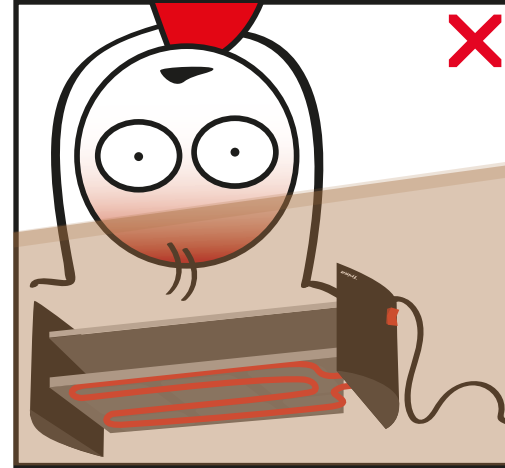

Untergrund • sol • fondo • underground

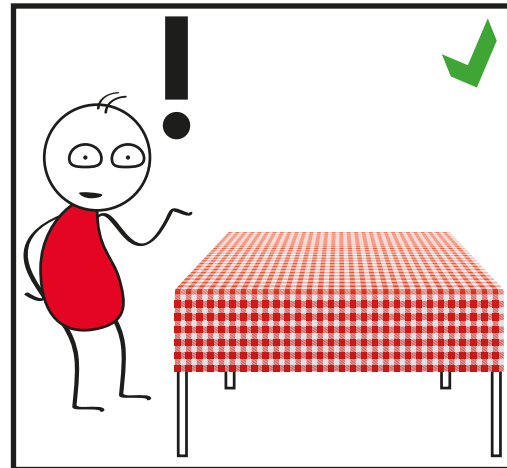
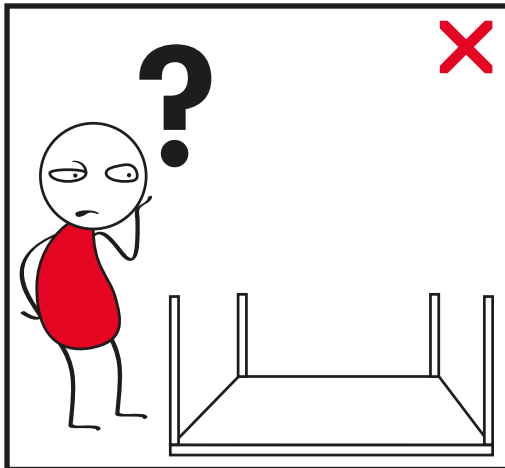

Anschalten • allumer • accendere • switch on

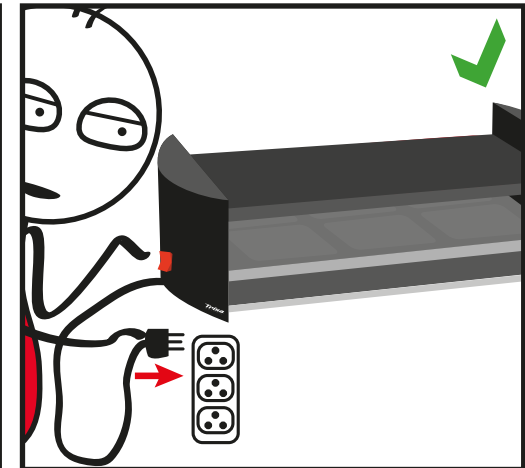
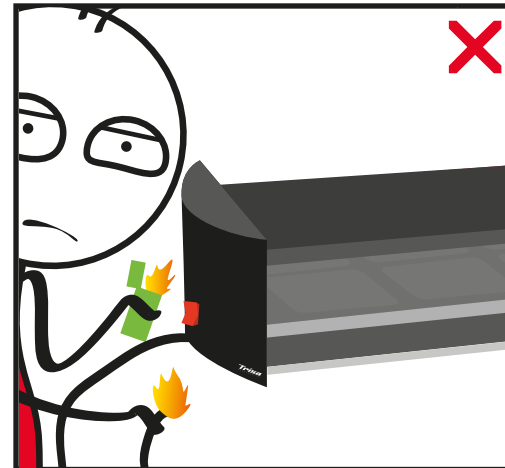

Anwenden • utilisation • uso • usage

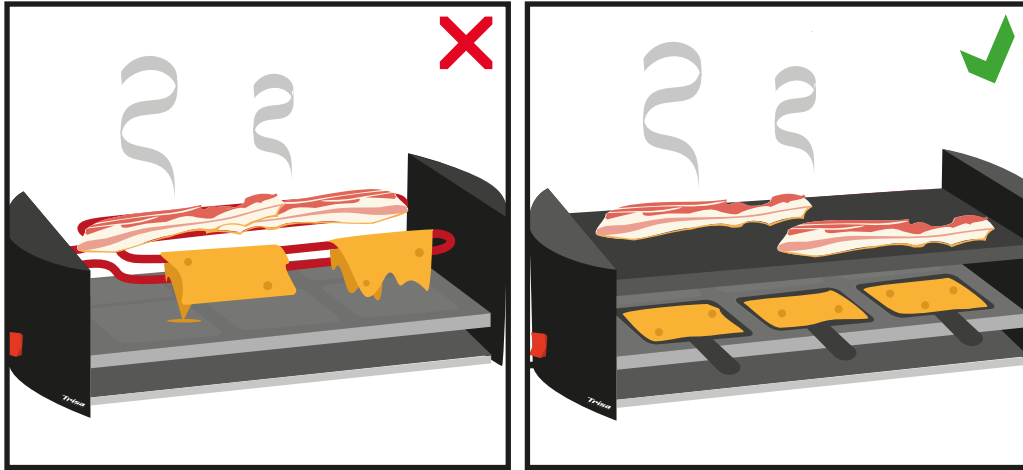

Geselligkeit • convivialité • socialità • sociability

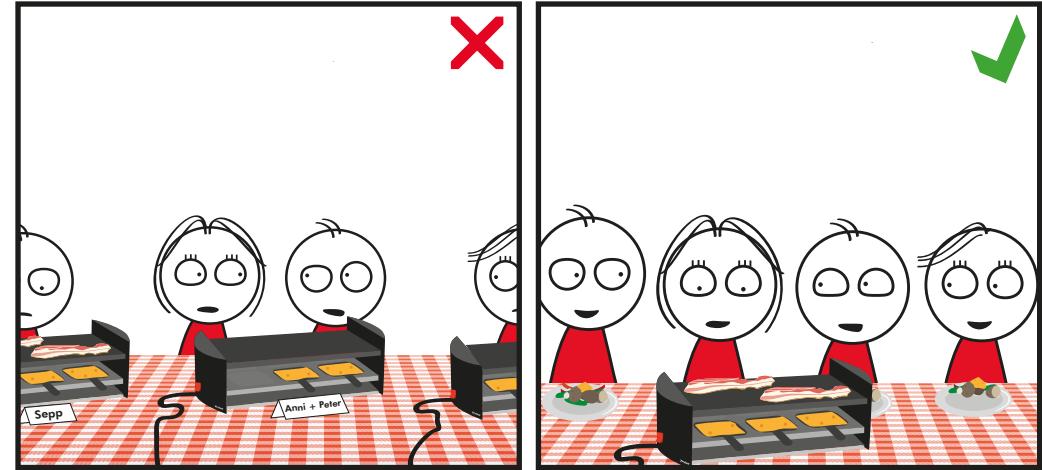

Beilagen • accompagnements • contorno • side dishes

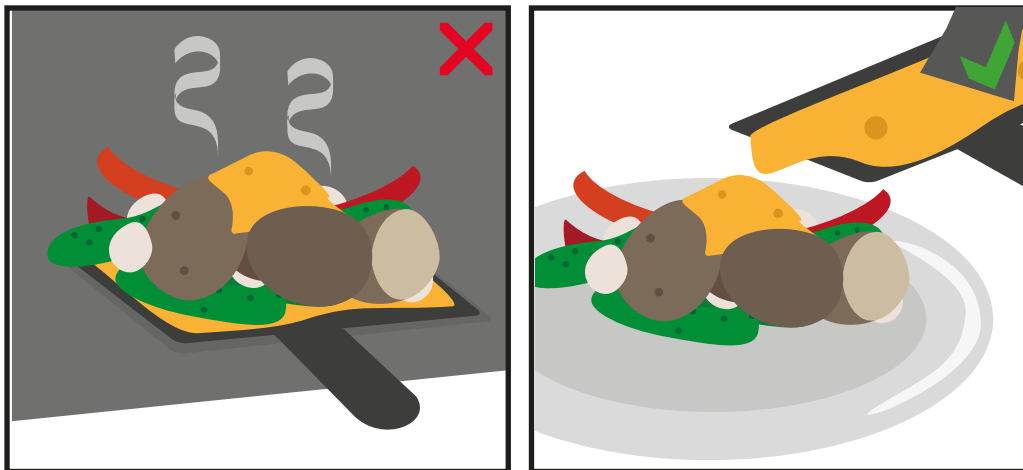

Feiertage • jours fériés • giorni festivi • holidays

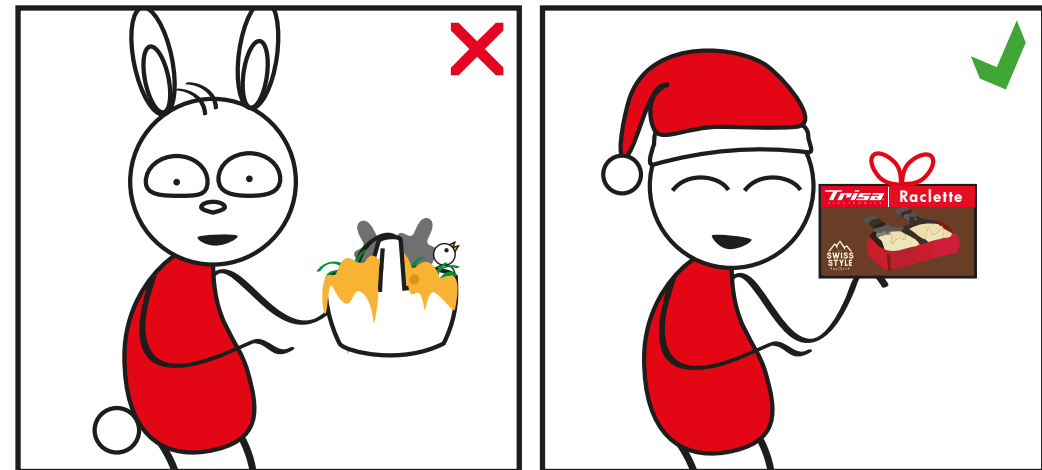

Ausschalten • éteindre • spegnere • shut down

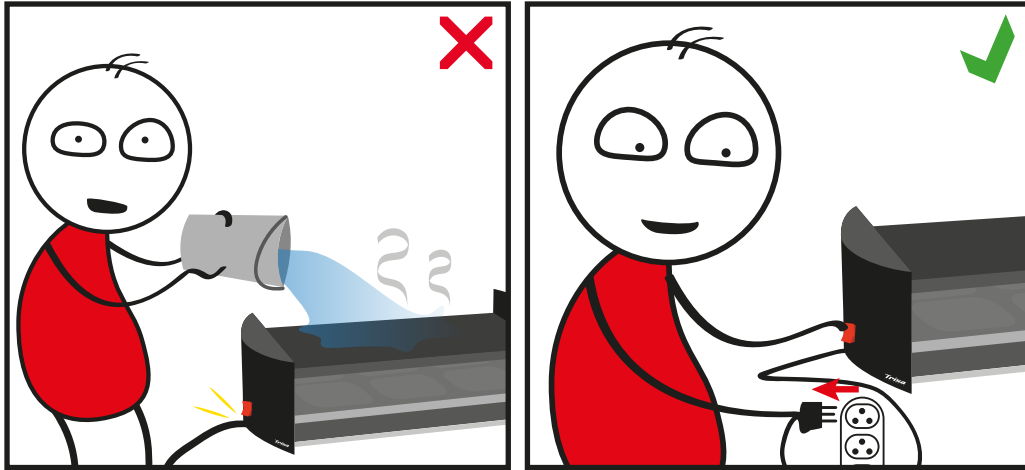

Erste Hilfe • premiers secours • pronto soccorso • first aid

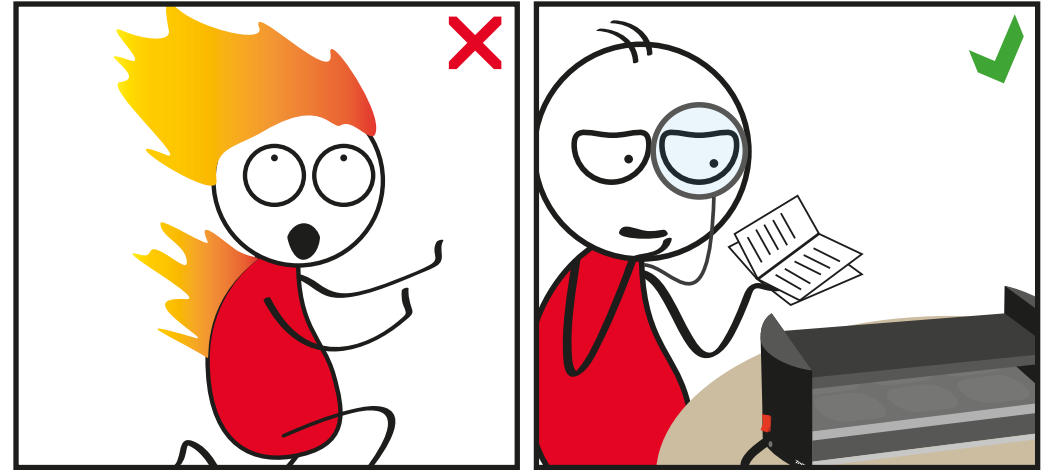

Reinigung • nettoyage • pulizia • cleaning

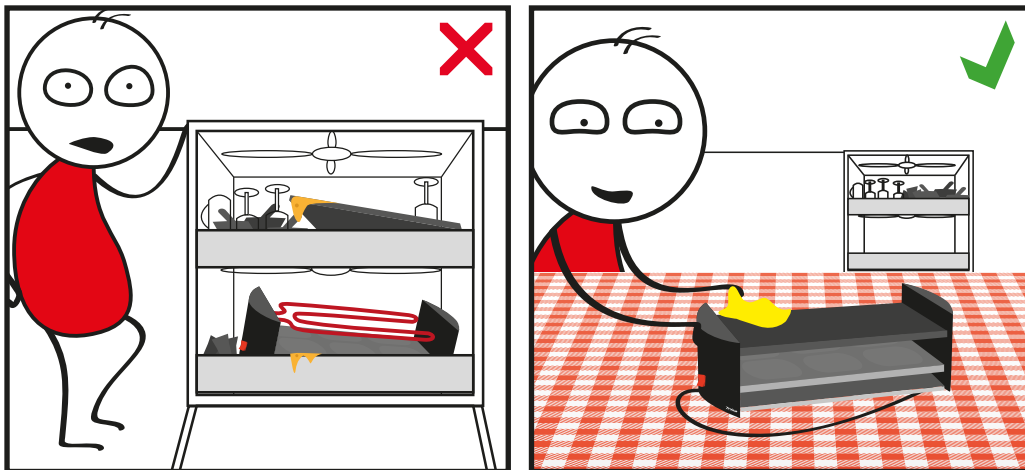

Reparatur • réparation • riparazione • repair

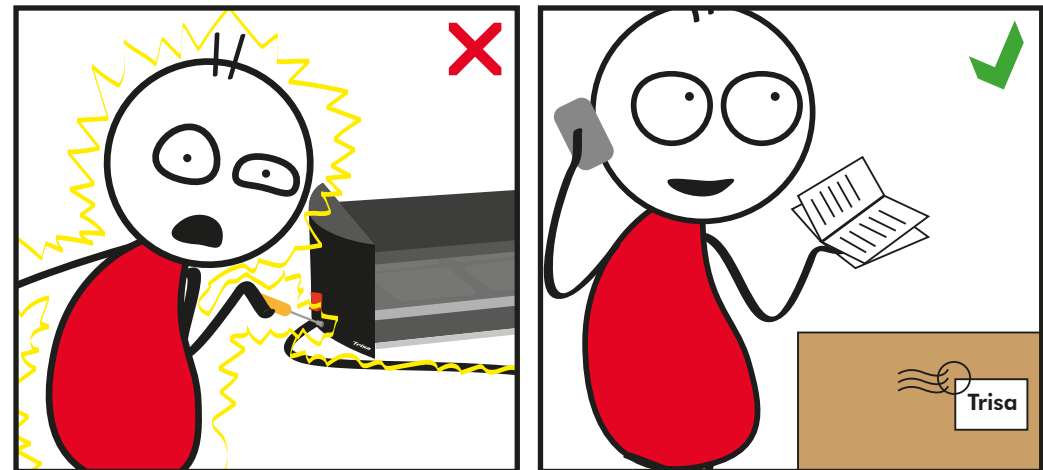

**Noch Fragen oder unsicher in der Verwendung?
Kontaktieren Sie uns:**

**Encore des questions ou des incertitudes concernant l'utilisation?
Contactez nous.**

**Altre domande o dubbi sull'utilizzo?
Contattateci.**

**Are there any questions or doubts about the usage?
Please contact us.**

+41 41 933 00 30